



FV SERIES STAINLESS STEEL HOUSINGS

- V-Band Closure for Quick Filter Change ** LEGS ARE STANDARD
- Accepts DOE and 222 Style
- Heavy Duty 304 or 316 Stainless Steel For Durability Available

FV SERIES STAINLESS STEEL HOUSINGS

LIQUATEC FV SERIES STAINLESS STEEL FILTER HOUSINGS

ideal for most industrial/commercial applications. With our welded leg design as a standard, not “optional” feature, eliminates the added expense to your application. Commonly used for pre-filtration to REVERSE OSMOSIS (RO) systems, Farms, Food Service, Car Washes, Agriculture and many other uses.

LIQUATEC FV SERIES STAINLESS STEEL FILTER HOUSINGS

use a high grade 304 stainless steel as standard not “L”, which is a lower grade stainless steel like most other manufactures. Our housings easily accept **Liquatec’s SDF, LX, DP and AR Series Cartridges**. With our wide range of models, options, and filter cartridges, these units can easily meet most any requirement.



Liquatec[™]
p r o d u c t s



FV SERIES STAINLESS STEEL HOUSINGS

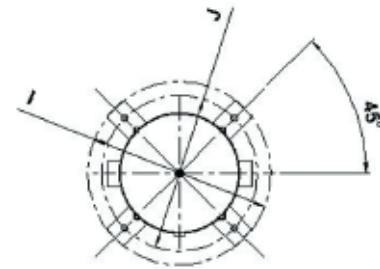
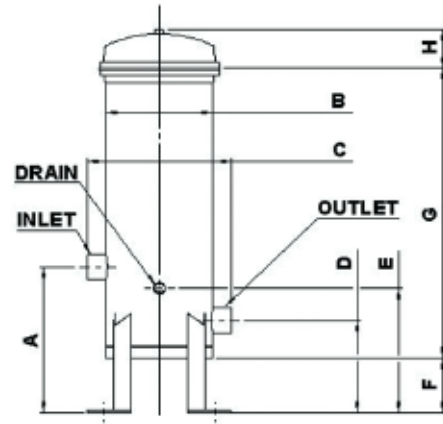

MATERIALS OF CONSTRUCTION

- **HOUSING** 304 AND 316 STAINLESS STEEL
- **CLOSURE** STAINLESS STEEL
- **O-RINGS** EPDM (FDA GRADE)
- **MAX. PRES/TEMP** 150 PSI @ 200°F

OPTIONAL FEATURES

1. Electro Polishing
2. Gauge Ports
3. Gauges Installed
4. 316 Stainless Steel
5. Filters DOE and 222 Installed

7 ROUND 304 STAINLESS STEEL HOUSING

MODEL	A	B	C	D	E	F	G	H	I	J
FV-710-2	13.4	10	13.3	8.5	11.4	5	16.53	3.7	16.85	14.33
FV-720-2	13.4	10	13.3	8.5	11.4	5	26.53	3.7	16.85	14.33
FV-730-2	13.4	10	13.3	8.5	11.4	5	36.53	3.7	16.85	14.33
FV-740-2	13.4	10	13.3	8.5	11.4	5	46.53	3.7	16.85	14.33

7 ROUND 316 STAINLESS STEEL HOUSING

MODEL	A	B	C	D	E	F	G	H	I	J
FVS-710-2	13.4	10	13.3	8.5	11.4	5	16.53	3.7	16.85	14.33
FVS-720-2	13.4	10	13.3	8.5	11.4	5	26.53	3.7	16.85	14.33
FVS-730-2	13.4	10	13.3	8.5	11.4	5	36.53	3.7	16.85	14.33
FVS-740-2	13.4	10	13.3	8.5	11.4	5	46.53	3.7	16.85	14.33

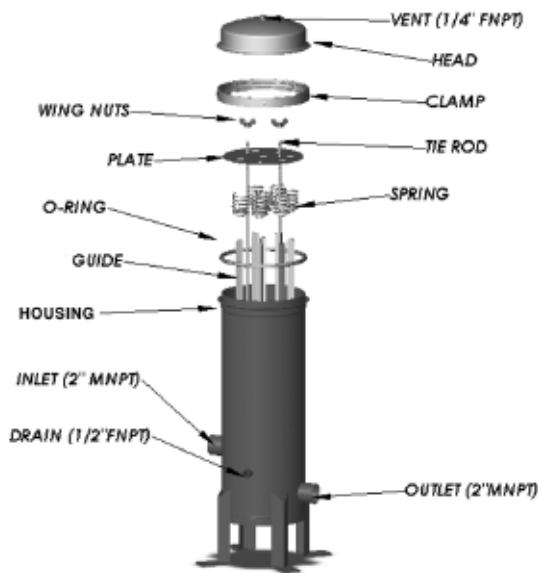

DISTRIBUTED BY: